



VGA02Z(EU)

VGA CONVERTER



FEATURES

- Supports DVR by Monitor Out
- Two Options for Output Resolution Selectable, Up to 1280 x 1024@60Hz
- Easy Installation
- NTSC / PAL Video System Auto Detection

CONNECTION

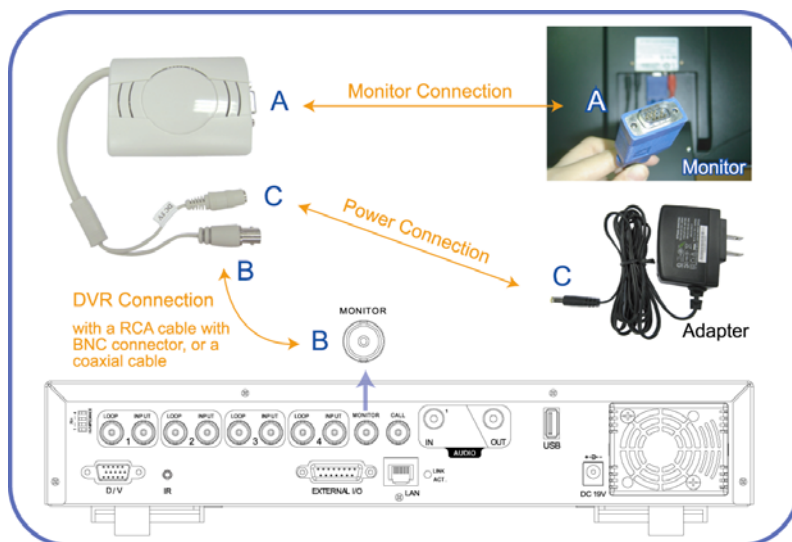

SPECIFICATIONS

VGA02Z(EU)

Connection	DVR Side: MONITOR OUT Monitor Side: D-Sub (VGA)
Function	1. Two Options for Output Resolution: > 1024×768@60Hz > 1280 x 1024@60Hz 2. Analog non-interlaced RGB Output Supported 3. NTSC / PAL System Auto Detection
Power	External adaptor DC12V @ 0.5A
Power Consumption (±10%)	2.5W
Dimensions (mm)**	87(L) × 64(W) × 24(H)

* The specifications are subject to change without notice.

** Dimensional Tolerance: ± 5mm